

ANNEXATION MAP NO. 50 (THREE SIXTY STORAGE CENTER)  
COMMUNITY FACILITIES DISTRICT NO. 2012-2  
(PUBLIC SAFETY SERVICES, OPEN SPACE OPERATION, AND PARK MAINTENANCE)

Vicinity Map

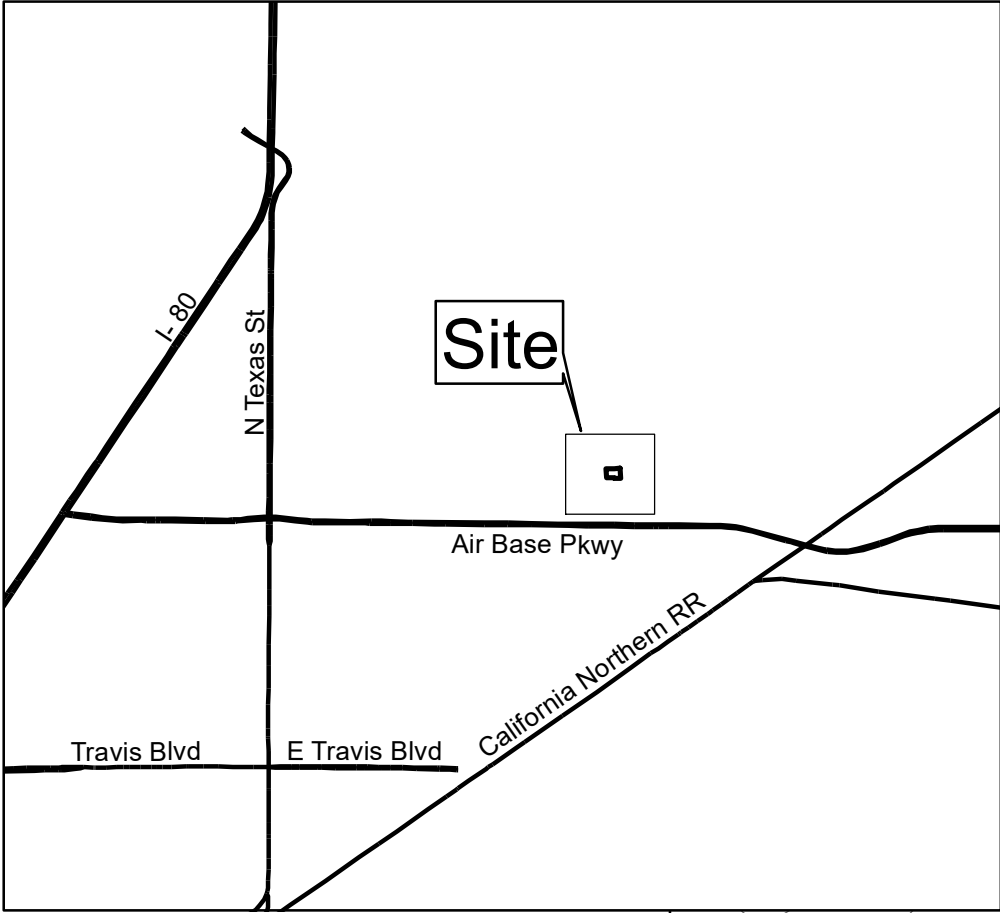

CITY OF FAIRFIELD  
COUNTY OF SOLANO  
STATE OF CALIFORNIA

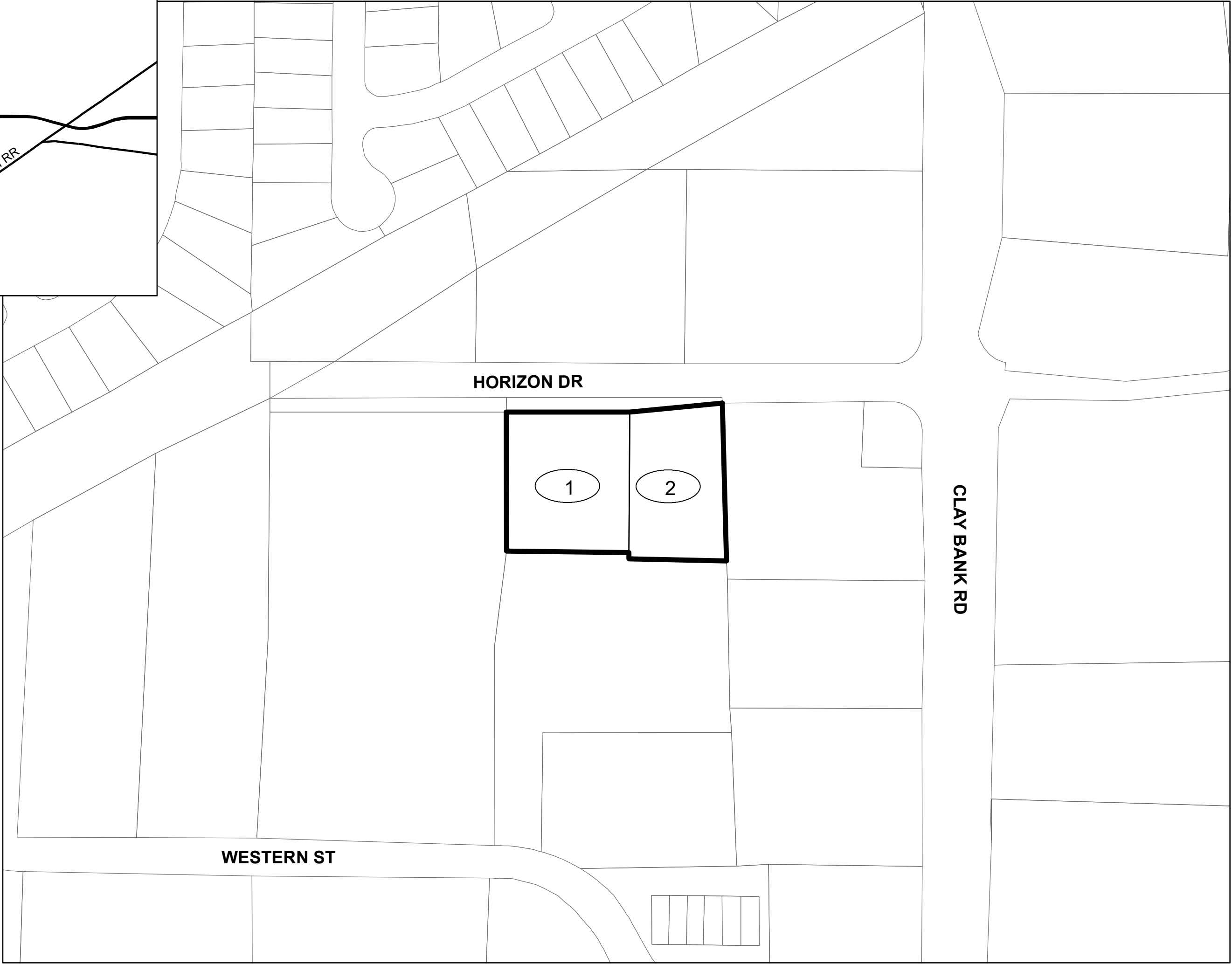

Legend

- Annexation No. 50
- Map Reference Number

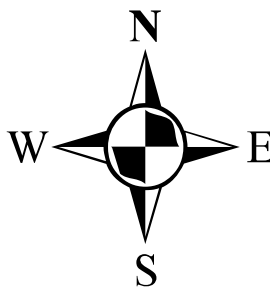

MAP REFERENCE NUMBER	ASSESSOR'S PARCEL NUMBER
1	0168-320-450
2	0168-320-460

FILED IN THE OFFICE OF THE CITY CLERK THIS \_\_\_\_\_ DAY  
OF \_\_\_\_\_, 20\_\_\_\_.

I HEREBY CERTIFY THAT THE WITHIN MAP SHOWING PROPOSED  
BOUNDARIES OF ANNEXATION MAP NO. 50(THREE SIXTY STORAGE  
CENTER) OF COMMUNITY FACILITIES DISTRICT NO. 2012-2 (PUBLIC  
SAFETY SERVICES, OPEN SPACE OPERATION, AND PARK  
MAINTENANCE), CITY OF FAIRFIELD, COUNTY OF SOLANO, STATE OF  
CALIFORNIA, WAS APPROVED BY THE CITY COUNCIL OF THE CITY  
OF FAIRFIELD AT A REGULAR MEETING, THEREOF, HELD ON THE  
\_\_\_\_\_ DAY OF \_\_\_\_\_, 20\_\_\_\_, BY ITS RESOLUTION NO.  
\_\_\_\_\_.

\_\_\_\_\_  
CITY CLERK  
CITY OF FAIRFIELD

FILED THIS \_\_\_\_\_ DAY OF \_\_\_\_\_, 20\_\_\_\_,  
AT THE HOUR OF \_\_\_\_\_ O'CLOCK \_\_\_\_\_M. IN BOOK  
\_\_\_\_\_ PAGE(S) \_\_\_\_\_ OF MAPS OF ASSESSMENT AND  
COMMUNITY FACILITIES DISTRICT AND INSTRUMENT NO.  
\_\_\_\_\_ IN THE OFFICE OF THE COUNTY RECORDER IN  
THE COUNTY OF SOLANO, STATE OF CALIFORNIA.

MARC C. TONNESEN, ASSESSOR/RECORDER

\_\_\_\_\_  
BY DEPUTY  
COUNTY RECORDER  
COUNTY OF SOLANO  
STATE OF CALIFORNIA

REFERENCE IS MADE TO THAT BOUNDARY OF COMMUNITY  
FACILITIES DISTRICT NO. 2012-2 (PUBLIC SAFETY SERVICES, OPEN  
SPACE OPERATION, AND PARK MAINTENANCE) OF THE CITY OF  
FAIRFIELD RECORDED WITH THE SOLANO COUNTY RECORDER'S  
OFFICE ON DECEMBER 28, 2012, IN BOOK 24 OF MAPS OF  
ASSESSMENT AND COMMUNITY FACILITIES DISTRICT ON PAGES 87-  
100.

THE LINES AND DIMENSIONS OF EACH LOT OR PARCEL SHOWN ON  
THIS DIAGRAM SHALL BE THOSE LINES AND DIMENSIONS AS  
SHOWN ON THE SOLANO COUNTY ASSESSOR'S MAPS FOR THOSE  
PARCELS LISTED.

THE SOLANO COUNTY ASSESSOR'S MAP SHALL GOVERN FOR ALL  
DETAIL CONCERNING THE LINES AND DIMENSIONS OF SUCH LOTS  
OR PARCELS.

