

Exhibit A

City of Fairfield Community Facilities District No. 2012-2 (Public Safety Services, Open Space Operation and Park Maintenance) Boundary Map - Annexation No. 46

ANNEXATION MAP NO. 46 (7 FLAGS EXPRESS CAR WASH)

SHEET 1 OF 1

COMMUNITY FACILITIES DISTRICT NO. 2012-2

(PUBLIC SAFETY SERVICES, OPEN SPACE OPERATION, AND PARK MAINTENANCE)

Vicinity Map

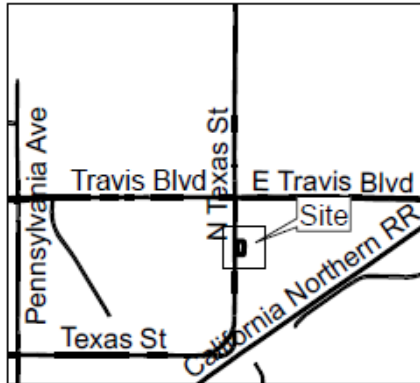

CITY OF FAIRFIELD
COUNTY OF SOLANO
STATE OF CALIFORNIA

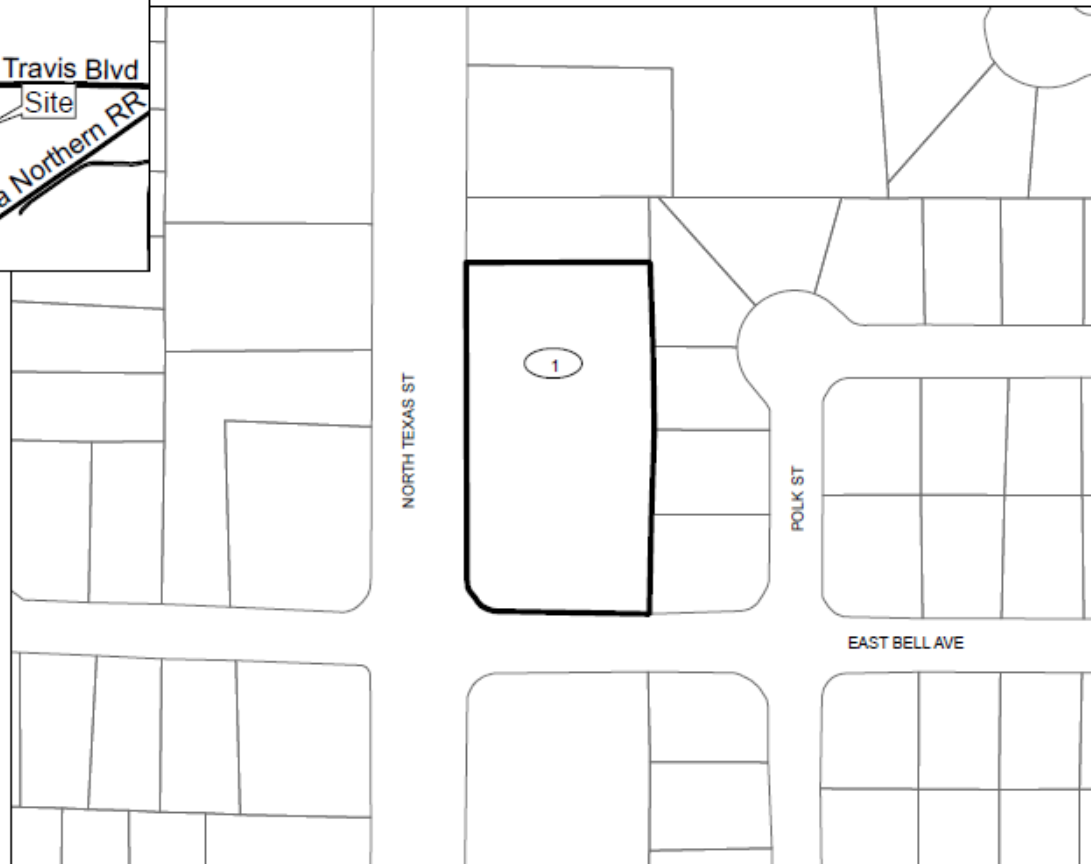

FILED IN THE OFFICE OF THE CITY CLERK THIS _____ DAY
OF _____, 20____

I HEREBY CERTIFY THAT THE WITHIN MAP SHOWING PROPOSED
BOUNDARIES OF ANNEXATION MAP NO. 46 (7 FLAGS EXPRESS CAR
WASH), OF COMMUNITY FACILITIES DISTRICT NO. 2012-2 (PUBLIC
SAFETY SERVICES, OPEN SPACE OPERATION, AND PARK
MAINTENANCE), CITY OF FAIRFIELD, COUNTY OF SOLANO, STATE OF
CALIFORNIA, WAS APPROVED BY THE CITY COUNCIL OF THE CITY
OF FAIRFIELD AT A REGULAR MEETING, THEREOF, HELD ON THE
_____ DAY OF _____, 20____, BY ITS RESOLUTION NO. _____

CITY CLERK
CITY OF FAIRFIELD

FILED THIS _____ DAY OF _____, 20____
AT THE HOUR OF _____ O'CLOCK _____ M. IN BOOK
_____ PAGE(S) _____ OF MAPS OF ASSESSMENT AND
COMMUNITY FACILITIES DISTRICT AND INSTRUMENT NO. _____
IN THE OFFICE OF THE COUNTY RECORDER IN
THE COUNTY OF SOLANO, STATE OF CALIFORNIA.

MARC C. TONNESEN, ASSESSOR/RECORDER

BY DEPUTY
COUNTY RECORDER
COUNTY OF SOLANO
STATE OF CALIFORNIA

REFERENCE IS MADE TO THAT BOUNDARY OF COMMUNITY
FACILITIES DISTRICT NO. 2012-2 (PUBLIC SAFETY SERVICES, OPEN
SPACE OPERATION, AND PARK MAINTENANCE) OF THE CITY OF
FAIRFIELD RECORDED WITH THE SOLANO COUNTY RECORDER'S
OFFICE ON DECEMBER 28, 2012, IN BOOK 34 OF MAPS OF
ASSESSMENT AND COMMUNITY FACILITIES DISTRICT ON PAGES 87-
100.

THE LINES AND DIMENSIONS OF EACH LOT OR PARCEL SHOWN ON
THIS DIAGRAM SHALL BE THOSE LINES AND DIMENSIONS AS
SHOWN ON THE SOLANO COUNTY ASSESSOR'S MAPS FOR THOSE
PARCELS LISTED.

THE SOLANO COUNTY ASSESSOR'S MAP SHALL GOVERN FOR ALL
DETAIL CONCERNING THE LINES AND DIMENSIONS OF SUCH LOTS
OR PARCELS.

Legend

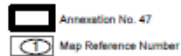

MAP REFERENCE NUMBER	ASSESSOR'S PARCEL NUMBER
1	0030-121-540